

Seating at Lynn Museum

A variety of seating options are available throughout the museum to support visitor comfort and accessibility.



Main Gallery - near Medieval Lynn case:
One chair with arms
Seat Width 46cm
Depth 50cm



Main Gallery - near Maritime Heritage case and recreated shop:
One chair with no arms
These chairs are foldable and can be carried around the museum
Seat Width 39cm
Depth 39.5cm



Seahenge Gallery - resources table:
Two chairs with arms
Seat Width 46cm
Depth 50cm



Reception - to right of desk:
One chairs with no arms
Seat Width 42cm
Depth 41cm

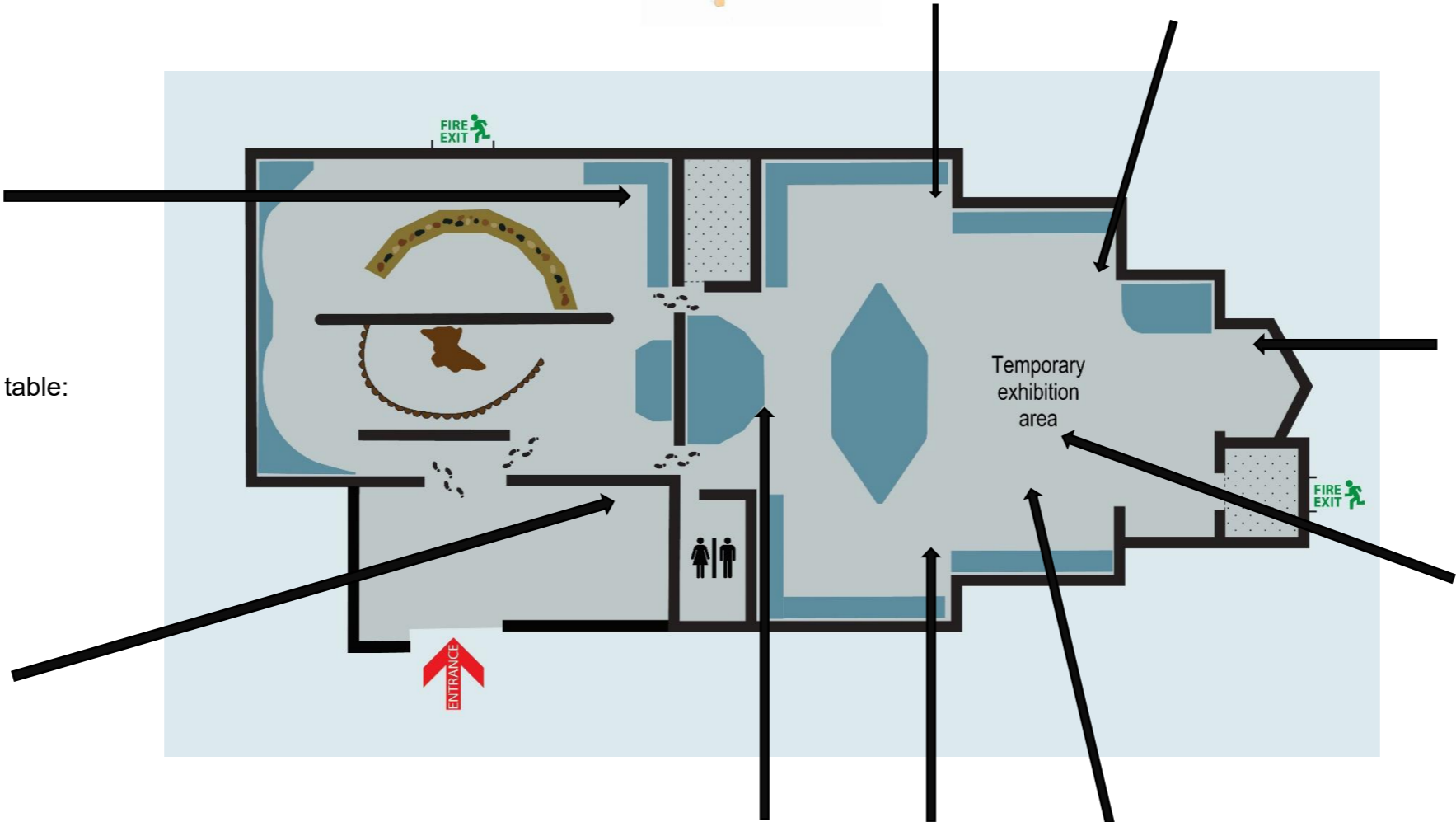

Main Gallery - temporary exhibition area:
One small sofa
Seat Width 120cm
Depth 43.5cm



Main Gallery - temporary exhibition area:
Two chairs with no arms
Seat Width 46cm
Depth 40cm



Main Gallery - near Carousel display:
Two chairs with no arms
These chairs are foldable and can be carried around the museum
Seat Width 39cm
Depth 39.5cm



Main Gallery - near Working Life case:
One chairs with arms
Seat Width 46cm
Depth 50cm



Main Gallery - activity table:
Two chairs with no arms
Seat Width 40cm
Depth 46cm